



# LP Series-General Purpose LP12-6.5(12V6.5Ah)



## Specifications

Rated Voltage	12V	
Nominal Capacity	6.5Ah	(C <sub>20</sub> , 1.75V/cell)
Dimension	Length	151±2mm (5.94 inches)
	Width	51±1mm (2.01 inches)
	Container Height	93±1mm (3.66 inches)
	Total Height	99±1mm (3.90 inches)
Approx Weight	1.82 Kg (4.01 lbs)	
Terminal	T1/T2	
Container Material	ABS	
Rated Capacity (25°C)	6.50 Ah	(20hr, 0.325A, 1.75V/cell)
	6.15 Ah	(10hr, 0.615A, 1.75V/cell)
	5.55 Ah	(5hr, 1.11A, 1.75V/cell)
	4.89 Ah	(3hr, 1.63A, 1.75V/cell)
	4.17 Ah	(1hr, 4.17A, 1.60V/cell)
Max. Discharge Current	98A (5s)	
Internal Resistance (25°C)	Approx 25mΩ	
Operating Temp. Range	Discharge	-15 ~ 50°C (5 ~ 122°F)
	Charge	-20 ~ 40°C (-4 ~ 104°F)
	Storage	-15 ~ 40°C (5 ~ 104°F)
Nominal Operating Temp. Range	25±3°C (77±5°F)	
Cycle Use	Initial Charging Current less than 1.95A. Voltage 14.4V~15.0V at 25°C(77°F)Temp. Coefficient -30mV/°C	
	Standby Use	
Effect of temp. to Capacity	Initial Charging Current less than 1.95A. Voltage 13.5V~13.8V at 25°C(77°F)Temp. Coefficient -20mV/°C	
	40°C (104°F)	103%
	25°C (77°F)	100%
Self Discharge	0°C (32°F)	
	LP series batteries may be stored for up to 6 months at 25°C(77°F) and then a freshening charge is required. For higher temperatures the time interval will be shorter.	

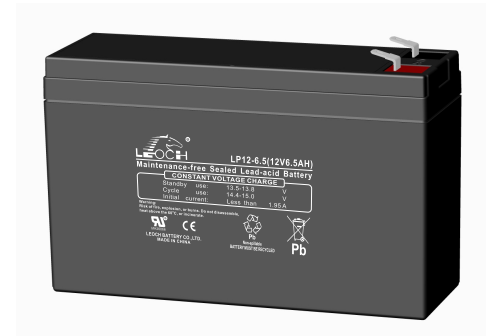

## Layout

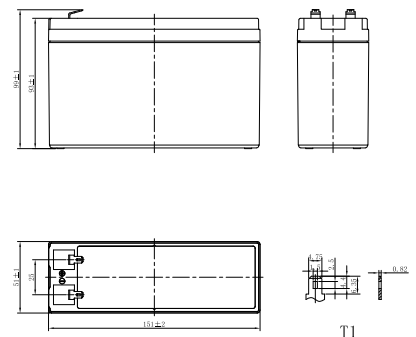

## Constant Current Discharge (Amperes) at 25 °C (77°F)

F.V/Time	5min	10min	15min	20min	30min	45min	1h	1.5h	2h	3h	4h	5h	6h	8h	10h	20h
1.85V/cell	19.4	13.3	10.4	8.50	6.26	4.59	3.77	2.77	2.18	1.58	1.26	1.08	0.927	0.732	0.601	0.318
1.80V/cell	20.9	14.1	10.9	8.84	6.45	4.71	3.86	2.83	2.22	1.61	1.28	1.09	0.941	0.743	0.609	0.321
1.75V/cell	22.0	14.7	11.2	9.09	6.62	4.81	3.94	2.88	2.26	1.63	1.30	1.11	0.952	0.751	0.615	0.325
1.70V/cell	23.1	15.3	11.6	9.35	6.79	4.92	4.01	2.93	2.30	1.66	1.32	1.12	0.964	0.759	0.621	0.328
1.67V/cell	23.9	15.7	11.9	9.54	6.91	5.00	4.08	2.97	2.32	1.67	1.33	1.13	0.972	0.765	0.625	0.330
1.60V/cell	25.3	16.4	12.3	9.83	7.09	5.13	4.17	3.03	2.37	1.70	1.35	1.15	0.986	0.776	0.633	0.334

## Constant Power Discharge (Watts/cell) at 25 °C (77°F)

F.V/Time	5min	10min	15min	20min	30min	45min	1h	1.5h	2h	3h	4h	5h	6h	8h	10h	20h
1.85V/cell	36.8	25.4	19.9	16.4	12.1	8.90	7.33	5.41	4.28	3.11	2.49	2.13	1.83	1.45	1.19	0.636
1.80V/cell	39.2	26.7	20.7	16.9	12.4	9.11	7.49	5.51	4.34	3.15	2.52	2.16	1.86	1.47	1.21	0.643
1.75V/cell	40.8	27.6	21.3	17.3	12.7	9.27	7.61	5.59	4.41	3.19	2.55	2.18	1.88	1.49	1.22	0.650
1.70V/cell	42.3	28.5	21.8	17.7	12.9	9.44	7.73	5.67	4.47	3.24	2.58	2.21	1.90	1.50	1.23	0.655
1.67V/cell	43.4	29.1	22.3	18.0	13.1	9.57	7.83	5.73	4.51	3.26	2.60	2.23	1.91	1.51	1.24	0.660
1.60V/cell	45.2	30.0	22.9	18.5	13.4	9.75	7.97	5.83	4.58	3.31	2.64	2.26	1.94	1.53	1.25	0.668



# LP Series-General Purpose LP12-6.5(12V6.5Ah)



## Applications

- All purpose
- Uninterruptable Power Supply (UPS)
- Electric Power System (EPS)
- Emergency backup power supply
- Alarm and security system
- Communication power supply
- DC power supply
- Auto control system

## General Features

- 5 years design life(25°C)
- Special exhaust structure and sealing technology, safe and reliable, flexible installation, convenient maintenance
- PbCaSn alloy for plate grids: less gassing, less self-discharging
- High quality AGM separator: extend cycle life and prevent micro short circuit
- High purity raw material: ensure low self discharge rate

## Standards

- Compliance with IEC 60896 standards, EU Battery Directive
- UL, CE Certified
- Manufactured in Leoch®IATF 16949, ISO45001, ISO 9001 and ISO 14001 certified production facilities

## Discharge Characteristics

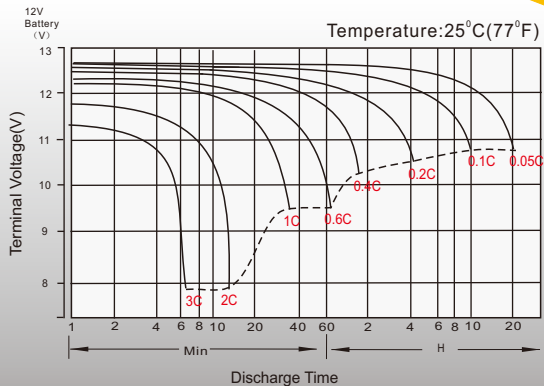

## Float Charging Characteristics

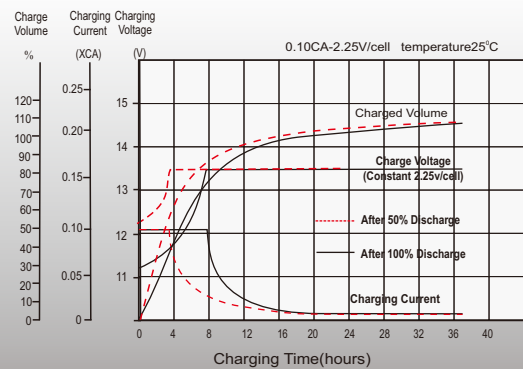

## Temperature Effects in Relation to Battery Capacity

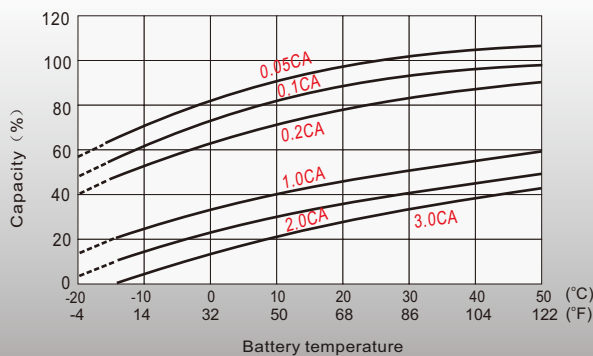

## Float Service Life

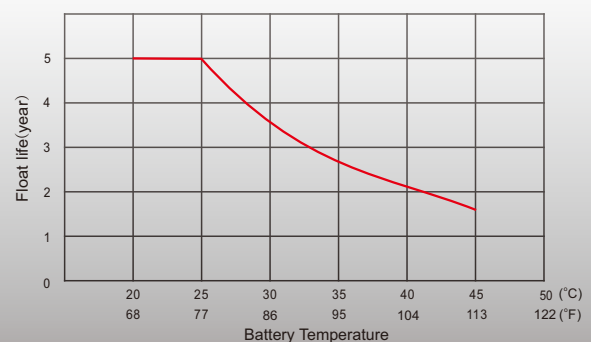

## Sales Offices Worldwide

### China Sales Office

5th Floor, Xinbaohui Bldg., Nanhai Blvd.,  
Nanshan, Shenzhen, China. 518052  
Tel: +86-755-86036060 (100 lines)  
Tel: +86-755-26067269  
Fax: +86-755-26067269  
E-mail: export@leoch.com

### HongKong Sales Office

Workshop C, 33/F, TML Tower, No. 3 Hoi Shing Road,  
Tsuen Wan, New Territories, Hong Kong  
Tel: +852 35786666  
Tel: +44(0) 1452 729428 / 1452 729696  
Fax: +44 1452 690125  
E-mail: sales.hk@leoch.com

### Singapore Sales Office

No. 1 Tech Park Crescent,  
Singapore 638131  
Tel: +65 68636078  
Tel: +65 6863 6079  
Fax: +65 6863 6079  
Email: sales.sg@Leoch.com

### Australia Sales Office

2 /29 Tarlington Place, Smithfield, NSW 2164  
Australia  
Tel: 02 9756 0950  
E-mail: sales.au@leoch.com

### North America Sales Office

19751 Descartes  
Foothill Ranch, CA 92610, USA  
Tel: 949-588-5853  
Tel: 949-588-5853  
Fax: 949-588-5966  
E-mail: sales@leoch.us  
Http:// www.leoch.us

### UK Sales Office

9B Wheatstone Court, Waterwells, Business Park,  
Gloucester, GL2-2AQ, UK United Kingdom  
Tel: +44(0) 1452 729428 / 1452 729696  
Tel: +44 1452 690125  
Fax: +44 1452 690125  
E-mail: Sales.Europe@leoch.com  
Http:// www.leoch.eu

### EMEA Sales Office

1 Deligiorgi St., 121 31 Athens,  
Greece  
Tel: +30 210 5760318 (2 lines)  
Tel: +30 210 5760318 (2 lines)  
E-mail: support\_EMEA@leoch.com  
Http:// www.leoch.eu

### India Sales Office

Shed no.A-53(b), 2nd Stage of Peenya Industrial Area,  
Bangalore North Taluk, Bangalore-560058, India  
Tel: +91-80-23440018/23440019  
Tel: +91-80-23440017  
Tel: +91-80-23440017  
E-mail: indiasales@leoch.com



[Http://www.leoch.com](http://www.leoch.com)

© 2020 LEOCH. All rights reserved.

Trademarks and logos are the property of LEOCH and its affiliates unless otherwise noted.  
Subject to revisions without prior notice.

Publication No.: LB-LP12-6.5-PD-EN-V2.0-202004