



# LP Series-General Purpose

## LP6-1.0(6V1.0Ah)



### Specifications

Rated Voltage	6V	
Nominal Capacity	1.0Ah	(C <sub>20</sub> , 1.75V/cell)
Dimension	Length	51±1mm (2.01 inches)
	Width	42±1mm (1.65 inches)
	Container Height	51±1mm (2.01 inches)
	Total Height	57±1mm (2.24 inches)
Approx Weight	0.25 Kg (0.55 lbs)	
Terminal	T1	
Container Material	ABS	
Rated Capacity (25°C)	1.00 Ah	(20hr, 0.050A, 1.75V/cell)
	0.95 Ah	(10hr, 0.095A, 1.75V/cell)
	0.88 Ah	(5hr, 0.176A, 1.75V/cell)
	0.774 Ah	(3hr, 0.258A, 1.75V/cell)
	0.642 Ah	(1hr, 0.642A, 1.60V/cell)
Max. Discharge Current	15A (5s)	
Internal Resistance (25°C)	Approx 60mΩ	
Operating Temp. Range	Discharge	-15 ~ 50°C (5 ~ 122°F)
	Charge	-20 ~ 40°C (-4 ~ 104°F)
	Storage	-15 ~ 40°C (5 ~ 104°F)
Nominal Operating Temp. Range	25±3°C (77±5°F)	
Cycle Use	Initial Charging Current less than 0.3A. Voltage 7.2V~7.5V at 25°C(77°F)Temp. Coefficient -15mV/°C	
Standby Use	Initial Charging Current less than 0.3A. Voltage 6.75V~6.9V at 25°C(77°F)Temp. Coefficient -10mV/°C	
Effect of temp. to Capacity	40°C (104°F)	103%
	25°C (77°F)	100%
	0°C (32°F)	86%
Self Discharge	LP series batteries may be stored for up to 6 months at 25°C(77°F) and then a freshening charge is required. For higher temperatures the time interval will be shorter.	



### Layout

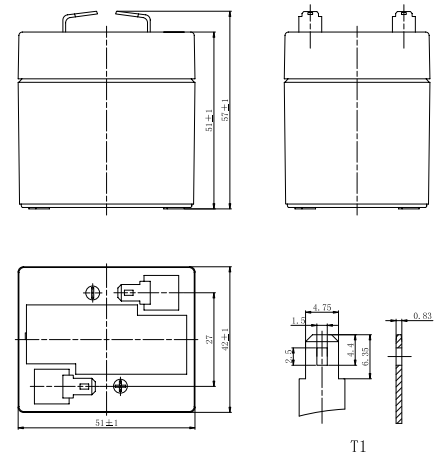

### Constant Current Discharge (Amperes) at 25 °C (77°F)

F.V/Time	5min	10min	15min	20min	30min	45min	1h	1.5h	2h	3h	4h	5h	6h	8h	10h	20h
1.85V/cell	2.79	1.74	1.43	1.14	0.850	0.636	0.581	0.428	0.341	0.250	0.202	0.172	0.147	0.116	0.092	0.049
1.80V/cell	3.00	1.85	1.50	1.19	0.877	0.653	0.595	0.437	0.347	0.254	0.205	0.174	0.149	0.118	0.094	0.049
1.75V/cell	3.16	1.92	1.55	1.22	0.900	0.667	0.607	0.445	0.354	0.258	0.207	0.176	0.151	0.119	0.095	0.050
1.70V/cell	3.31	2.00	1.60	1.26	0.922	0.682	0.618	0.453	0.359	0.262	0.210	0.179	0.153	0.120	0.096	0.050
1.67V/cell	3.43	2.06	1.64	1.29	0.939	0.693	0.628	0.459	0.363	0.264	0.212	0.180	0.154	0.121	0.096	0.051
1.60V/cell	3.63	2.14	1.69	1.32	0.964	0.710	0.642	0.468	0.370	0.269	0.216	0.183	0.156	0.123	0.097	0.051

### Constant Power Discharge (Watts/cell) at 25 °C (77°F)

F.V/Time	5min	10min	15min	20min	30min	45min	1h	1.5h	2h	3h	4h	5h	6h	8h	10h	20h
1.85V/cell	5.28	3.32	2.73	2.21	1.64	1.23	1.13	0.836	0.668	0.491	0.398	0.339	0.291	0.230	0.184	0.098
1.80V/cell	5.62	3.50	2.85	2.28	1.69	1.26	1.15	0.851	0.679	0.498	0.403	0.343	0.295	0.233	0.186	0.099
1.75V/cell	5.86	3.61	2.92	2.33	1.72	1.28	1.17	0.864	0.689	0.504	0.407	0.347	0.298	0.235	0.188	0.100
1.70V/cell	6.08	3.73	3.00	2.39	1.76	1.31	1.19	0.877	0.697	0.511	0.412	0.352	0.301	0.237	0.189	0.101
1.67V/cell	6.24	3.81	3.07	2.43	1.79	1.33	1.21	0.886	0.704	0.515	0.416	0.354	0.304	0.239	0.191	0.102
1.60V/cell	6.49	3.92	3.15	2.49	1.83	1.35	1.23	0.901	0.715	0.523	0.422	0.359	0.307	0.242	0.193	0.103



# LP Series-General Purpose LP6-1.0(6V1.0Ah)



## Applications

- All purpose
- Uninterruptable Power Supply (UPS)
- Electric Power System (EPS)
- Emergency backup power supply
- Alarm and security system
- Communication power supply
- DC power supply
- Auto control system

## General Features

- 5 years design life(25°C)
- Special exhaust structure and sealing technology, safe and reliable, flexible installation, convenient maintenance
- PbCaSn alloy for plate grids: less gassing, less self-discharging
- High quality AGM separator: extend cycle life and prevent micro short circuit
- High purity raw material: ensure low self discharge rate

## Standards

- Compliance with IEC 60896 standards, EU Battery Directive
- UL, CE Certified
- Manufactured in Leoch®IATF 16949, ISO45001,ISO 9001 and ISO 14001 certified production facilities

## Discharge Characteristics

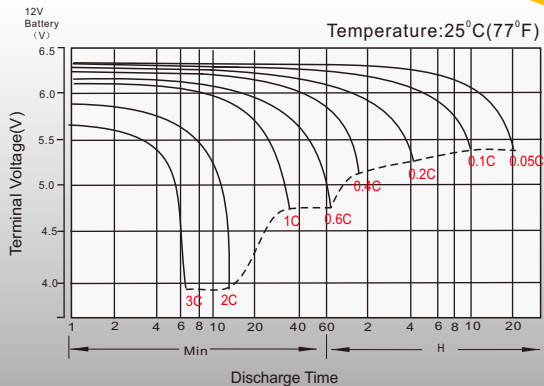

## Float Charging Characteristics

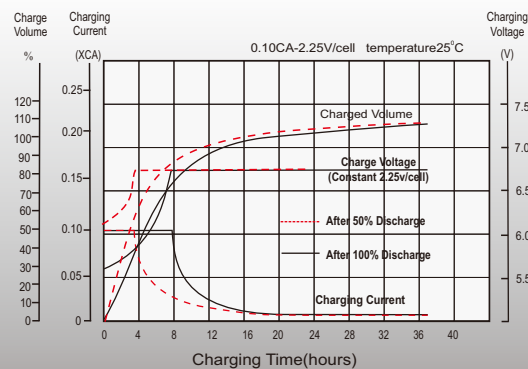

## Temperature Effects in Relation to Battery Capacity

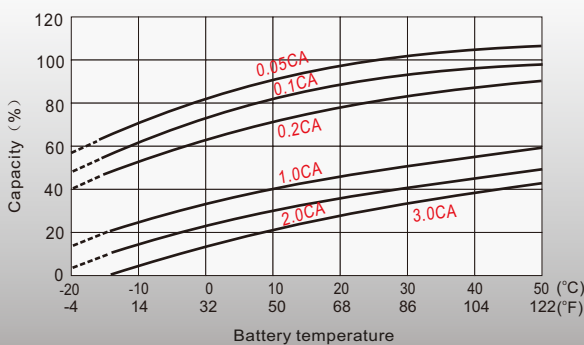

## Float Service Life

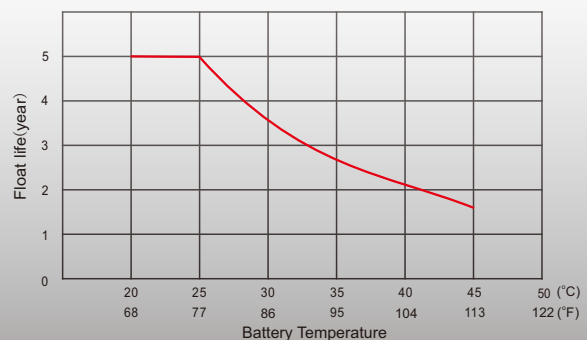

## Sales Offices Worldwide

### China Sales Office

5th Floor, Xinbaohui Bldg., Nanhai Blvd.,  
Nanshan, Shenzhen, China. 518052  
Tel: +86-755-86036060 (100 lines)  
Tel: +86-755-26067269  
E-mail: export@leoch.com

### HongKong Sales Office

Workshop C, 33/F, TML Tower, No. 3 Hoi Shing Road,  
Tsuen Wan, New Territories, Hong Kong  
Tel: +852 35786666  
Tel: +44(0) 1452 729428 / 1452 729696  
Fax: +44 1452 690125  
E-mail: sales.hk@leoch.com

### Singapore Sales Office

No. 1 Tech Park Crescent,  
Singapore 638131  
Tel: +65 68636078  
Tel: +65 6863 6079  
Email: sales.sg@Leoch.com

### Australia Sales Office

2 /29 Tarlington Place, Smithfield. NSW 2164  
Australia  
Tel: 02 9756 0950  
E-mail: sales.au@leoch.com

### North America Sales Office

19751 Descartes  
Foothill Ranch, CA 92610, USA  
Tel: 949-588-5853  
Tel: 949-588-5966  
E-mail: sales@leoch.us  
Http:// www.leoch.us

### UK Sales Office

9B Wheatstone Court. Waterwells, Business Park,  
Gloucester, GL2-2AQ, UK United Kingdom  
Tel: +44(0) 1452 729428 / 1452 729696  
Tel: +44 1452 690125  
E-mail: Sales.Europe@leoch.com  
Http:// www.leoch.eu

### EMEA Sales Office

1 Deligiorgi St., 121 31 Athens,  
Greece  
Tel: +30 210 5760318 (2 lines)  
Tel: support\_EMEA@leoch.com  
Http:// www.leoch.eu

### India Sales Office

Shed no.A-53(b), 2nd Stage of Peenya Industrial Area,  
Bangalore North Taluk, Bangalore-560058, India  
Tel: +91-80-23440018/23440019  
Tel: +91-80-23440017  
E-mail: indiasales@leoch.com



[Http://www.leoch.com](http://www.leoch.com)

© 2020 LEOCH. All rights reserved.

Trademarks and logos are the property of LEOCH and its affiliates unless otherwise noted.  
Subject to revisions without prior notice.

Publication No.: LB-LP6-1.0-PD-EN-V2.0-202004